



GPS Locator™

Operating Guide

Please read this entire guide before beginning.



Thank you for choosing PetSafe®, the best selling brand of electronic training solutions in the world. Our mission is to be the most trusted brand in the pet ownership experience. We want to ensure your pet's safety by providing you with the tools and techniques to successfully train your pet. If you have any questions, please contact the Customer Care Center at 1-866-900-1102 or visit our website at www.PetSafeGPSLocator.com.

To get the most protection out of your limited warranty, please register your product within 90 days at www.PetSafeGPSLocator.com. By registering, you will enjoy the product's full warranty and should you ever need to call the Customer Care Center, we will be able to help you faster. Additionally, you will not have to save your product receipt as registering serves as proof of purchase. Most importantly, PetSafe will never give or sell your valuable information to anyone.

Table of Contents

Components	3
Welcome	3
Charge Your Batteries	3
How the GPS Locator™ Works.....	4
Key Definitions	4
Getting Started	5
Install the Batteries.....	6
Setting up the PetSafe® GPS Locator™ and Home Zone™	7
Place the PetSafe GPS Locator on Your Pet's Collar.....	8
Taking Your Pet Outside of the Home Zone™	9
Finding Your Lost Pet	9
Replacing the Batteries	10
Using the PetSafe GPS Locator™ Away from Home	10
Using the PetSafe GPS Locator™ Web Site	10
Frequently Asked Questions	11
Product Warranty	13

Components

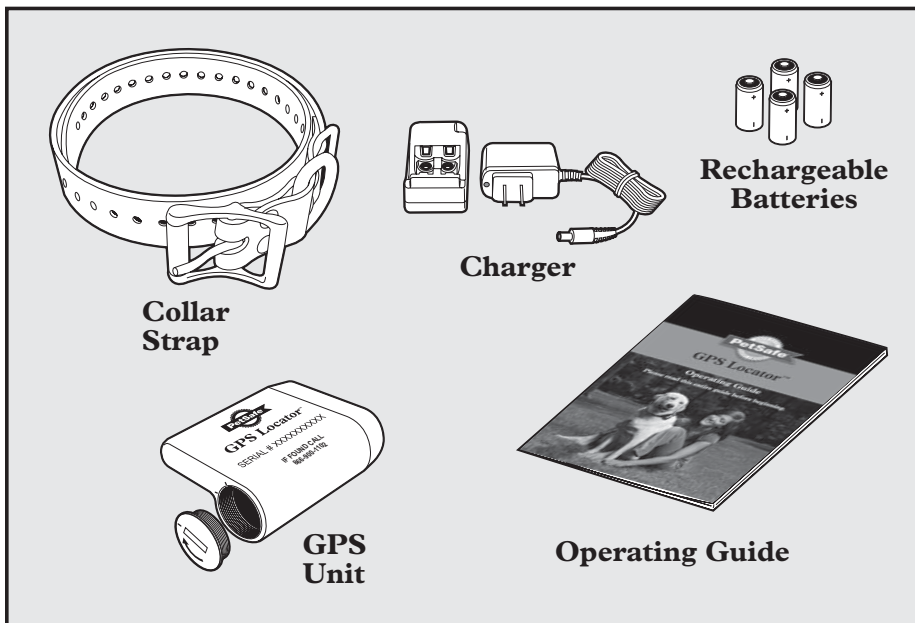

Welcome

Congratulations on your purchase of the PetSafe® GPS Locator™. The PetSafe GPS Locator is a battery-powered device that uses global positioning system (GPS), 2-way wireless technology, and a live support staff standing by 24 hours a day, 7 days a week, 365 days a year. We're ready to notify you and help you find your pet in the event it is lost.

Note: To use the PetSafe GPS Locator alert feature, you must have a home phone, or cell phone, or a Personal Digital Assistant (PDA) with Short Message Service (SMS) text-messaging or e-mail capability. Cell phone time, charged by your cellular provider, will apply; standard text-messaging rates will apply.

Charge Your Batteries

Before using the PetSafe GPS Locator, please charge your batteries using the included battery charger.

How the GPS Locator™ Works

The PetSafe® GPS Locator uses Global Positioning System tracking to pinpoint your dog's location day or night. You set your Home Zone™ area, and the system notifies you when your dog crosses the Home Zone boundary. Once you receive an Alert, our Customer Care Specialists stay on the line with you until you and your pet are back together.

- The PetSafe GPS Locator is programmed with a boundary (Home Zone) for your pet. You select the size and location of the Home Zone.
- If your pet roams outside of the Home Zone, the PetSafe GPS Locator identifies this event as an escape or boundary violation, and notifies the PetSafe Customer Care Center.
- The PetSafe GPS Locator then goes into Locate Mode. In this mode, the device continues monitoring your pet's location and provides your pet's GPS coordinates to the Customer Care Center, and to the website.
- You will receive a telephone voice message, text message, or e-mail to inform you of the boundary violation, and of the current location of your pet.
- Our Customer Care Specialists will stay on the line with you until you and your pet are back together again.

When you want to take your pet for a walk, you put the PetSafe GPS Locator into Walk Mode. This mode allows your pet to leave the Home Zone for a period of time without initiating a boundary violation. If your pet is outside of the Home Zone when Walk Mode expires, a boundary violation is initiated.

Also you will receive a telephone voice message, text message, or e-mail message when the PetSafe GPS batteries are running low and need to be replaced.

Key Definitions

Home Zone™: The circular boundary you set for your pet.

Monitor Mode: The operating status of the collar while in the Home Zone; the collar's default operating mode.

Walk Mode: Takes the collar out of Monitor Mode, allowing your pet to leave the Home Zone. Typically the collar is in Walk Mode for 45 minutes before automatically reverting back to Monitor Mode.

Locate Mode: The collar automatically sends its signal and notifies the Customer Care center. You can track the collar on-line using the website or via a cell phone call with our Customer Care Specialist. Note that the collar switches to Locate Mode either a) when it leaves the Home Zone, or b) when the Walk Mode time elapses and the collar is not in the Home Zone.

Mode Button: The control on your PetSafe GPS Locator that allows you to select modes.

Alerts: A notification to your home phone, cell phone, or e-mail account of a Home Zone set, Home Zone violation, or a Low Battery warning.

Getting Started

Before you can begin using the PetSafe® GPS Locator™, you need to complete the steps in the following sections.

To begin using the PetSafe GPS Locator, call the Customer Care Center at 1-866-900-1102. Customer Care Specialists are available Monday through Friday from 8 a.m. to 8 p.m. EST, and Saturday from 9 a.m. to 5 p.m. EST to help you register and activate your PetSafe GPS Locator. You also may register and activate your product at www.PetSafeGPSLocator.com. For better service we recommend calling our Customer Care Specialists.

During your initial call to the Customer Care Center, a Customer Care Specialist will guide you through the activation process. The Customer Care Specialist will ask you for the following information:

1. Serial number of the device:

Note: The serial number is located on the back (flat) side of the device. Please record your unique serial number in the box provided on the back of this guide.

2. Desired user name and password to use at the PetSafe GPS Locator web site. After you have completed the activation of your PetSafe GPS Locator, you can use the website to track your pet and communicate with the Customer Care Center.

3. Product registration information:

- Name
- Address
- Home phone
- Mobile phone
- E-mail address

4. Information about your pet:

- Name

5. Preferred notification method for PetSafe GPS Locator alerts:

- E-mail
- Text message
- Voice message

Select the notification method based on the capabilities of your home phone, cell phone, or PDA. You can specify up to two e-mail addresses or phone numbers for each notification method (for example, you can request that all e-mail messages be sent to both your business and personal e-mail addresses).

Recommended: You are encouraged to use any and all notification methods: Home phone, mobile phone, e-mail and text messaging to notify you with an Alert.

Your PetSafe GPS Locator is now registered. It may take 4 to 24 hours for the GPS to become activated.

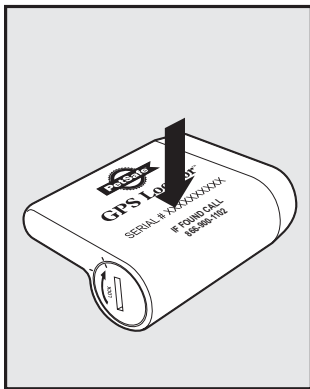

Install the Batteries

To install freshly charged batteries in the PetSafe® GPS Locator™:

1. Insert the edge of a coin into the slot on the cap and turn the battery cap counterclockwise to loosen it (A).
2. Remove the battery cap and set it aside.
3. Place two batteries, negative (flat) side down, into the battery cylinder (B).
4. Replace the battery cap on the cylinder and turn it clockwise with a coin to tighten it.
5. **Press the mode button once for 1/2 second to initialize the unit.**

Important: Do not over-tighten the battery cap. Once the cap stops it is secure.

Low Battery: The PetSafe GPS Locator will send you an Alert when the batteries need to be replaced. The Alert will be sent by voice message, text message, or e-mail depending upon the notification method you selected during product activation.

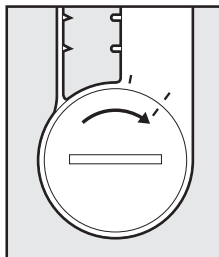
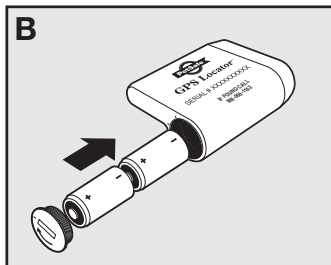
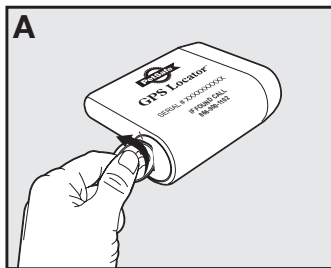

Remember

Home Zone™: The circular boundary you set for your pet.

Mode Button: The control on your PetSafe GPS Locator that allows you to select modes.

Setting up the PetSafe® GPS Locator™ and Home Zone™

Now that the batteries are installed, follow these steps to set-up the PetSafe GPS Locator:

The Home Zone is a circular boundary where you want your pet to remain. By default, the radius of the Home Zone is set to 300 feet (about 90 meters).

Note: You can change the radius of the Home Zone at any time by calling the Customer Care Center at 1-866-900-1102, or by using the PetSafe GPS Locator web site (www.PetSafeGPSLocator.com).

To set up your PetSafe GPS Locator and establish the center point of the Home Zone (boundary) for your pet:

1. Go outside and stand at the center point of the desired Home Zone. You must have a clear view of the sky to obtain an accurate location.
2. Press the Mode (Red) button for ½ second and then release it. The red and green lights on the device will flash together once, and then go out. You are now in Command Mode.
3. Press the Mode button 4 times in succession.
 - The red light will blink continuously until the location of the device is obtained (this may take up to 5 minutes);
 - The green light flashes for 5 seconds to confirm the Home Zone has been set.
 - Repeat Step 3 if unit did not set the Home Zone in the first 5 minute cycle.
4. If the red light stays solid for 5 seconds, the Home Zone was not successfully set. If the unit did not set Home Zone during the first 5 minute cycle, repeat Steps 2 and 3. It may take several cycles for unit to acquire a Home Zone, depending on environmental conditions.

Note: If the red light does not turn on, remove the battery cap to ensure the batteries are properly installed. Once you confirm the batteries are properly installed you can replace the battery cap. Repeat Steps 1-3.

The PetSafe GPS Locator is now set-up and in Monitor Mode.

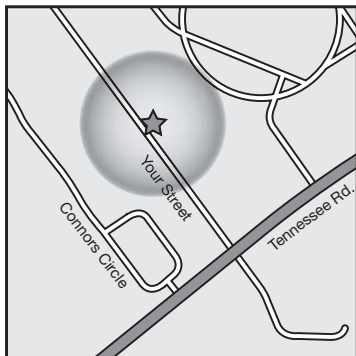
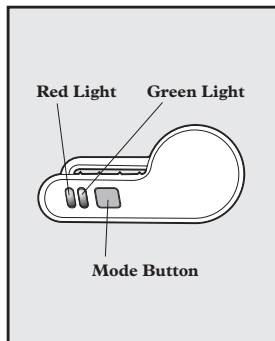

Lights and What They Mean

Color	Duration	Description
Red and Green	Solid 1 second	Unit is in Command Mode
Red	Flashing	Seeking GPS signal
Red	Solid 5 seconds	Home Zone was not set
Green	Flashes 5 seconds	Confirms Home Zone has been set
Green	Flashes 2 seconds	Unit is in Walk Mode
Green	Solid 2 seconds, then off	End Walk Mode; unit is in Monitor Mode

Place the PetSafe® GPS Locator™ on Your Pet's Collar

Install the PetSafe GPS Locator on the collar provided, or on any standard 1-inch collar with a buckle. Collars with a male/female snap mechanism are not compatible with the PetSafe GPS Locator.

To place the PetSafe GPS Locator on your pet's collar:

1. Place the PetSafe GPS Locator on a flat surface with the collar loops facing up.
2. With the collar facing up, thread the collar through the collar loops on the PetSafe GPS Locator.
3. Place the collar around your pet's neck. The PetSafe GPS Locator should be between your pet's neck and the collar, with the collar and collar loops visible. This will ensure the best performance from the unit.

You are now ready to begin using the PetSafe GPS Locator.

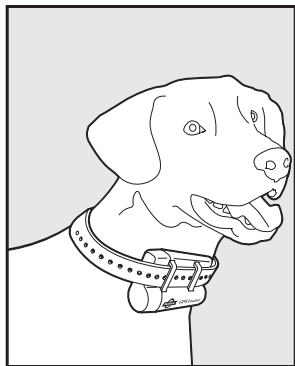
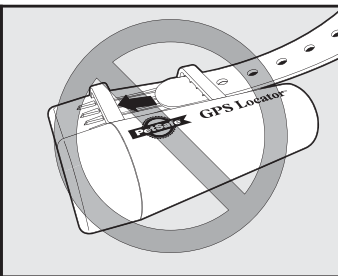
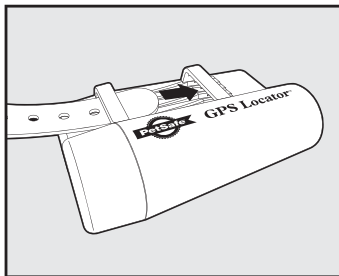

Remember

Home Zone™: The circular boundary you set for your pet.

Monitor Mode: The operating status of the collar while in the Home Zone; the collar's default operating mode.

Walk Mode: Takes the collar out of Monitor Mode, allowing your pet to leave the Home Zone. Typically the collar is in Walk Mode for 45 minutes before reverting automatically back to Monitor Mode.

Mode Button: The control on your PetSafe GPS Locator that allows you to select modes.

Taking Your Pet Outside of the Home Zone™

Before taking your pet for a walk, you will need to place the PetSafe® GPS Locator™ in Walk Mode. This allows you to take your pet outside of the Home Zone without initiating a boundary violation.

Note: the duration of Walk Mode is 45 minutes.

To take your pet for a walk:

1. Turn the PetSafe GPS Locator on, if you have not already done so (see “Setting-up the PetSafe GPS Locator”).
2. Press the Mode button for ½ second and then release it. The red and green lights flash on, then off. You are now in Command Mode. Press button again 2 times. The green light flashes for 2 seconds, and then turns off. This indicates that the PetSafe GPS Locator is in Walk Mode.
3. Take your pet for a walk.
4. When you return from your walk, turn off Walk Mode by pressing the Mode button again for ½ second. The red and green lights flash on, then off. You are now in Command Mode. Press button again 2 times. The green light glows solid for 2 seconds, and then turns off. This indicates that the PetSafe GPS Locator is back in Monitor Mode. Monitor Mode is the mode in which the device normally operates; it is used when your pet is safely within the Home Zone.

Note: to extend your Walk Mode beyond 45 minutes, do the following:

- Press the Mode button once to put the unit into Command Mode.
(The Red and Green lights will flash on and then turn off)
- Press the Mode button 2 times to exit Walk Mode.
(The Green light will glow solid for 2 seconds and then turn off)
- Press the Mode button once to put the unit into Command Mode.
(The Red and Green lights will flash on and then turn off)
- Press the Mode button 2 times to re-enter Walk Mode starting a new 45 minute duration.
(The Green light will flash for 2 seconds and then turn off)

Be sure to press the button in prompt secession to avoid getting a Home Zone violation alert.

Finding Your Lost Pet

If your pet strays from the Home Zone while wearing the PetSafe GPS Locator, a Customer Care Specialist will contact you by telephone voice message, text message, or e-mail (depending on the Alert method you selected when you set up the device), and will put the PetSafe GPS Locator in Location Mode.

When you are contacted, call the Customer Care Center at 1-866-900-1102 and choose option 1. A Customer Care Specialist will stay on the phone with you and provide turn-by-turn directions to where your pet is located. When you confirm that you have found your pet, the Customer Care Specialist will put the PetSafe GPS Locator back in Monitor Mode.

Note: If you are taking a walk with your pet and receive notification of a boundary violation, you may have forgotten to place the PetSafe GPS Locator in Walk Mode. To put the device in Walk Mode, press the Mode button for ½ second and then release it. The red and green lights flash on, then off. Press button again 2 times. The green light flashes for 2 seconds, confirming that the device is in Walk Mode.

Replacing the Batteries

To replace the batteries:

(Refer to illustrations in “Install the Batteries” on page 6)

1. Insert the edge of a coin in the slot on the cap and turn the battery cap counterclockwise to loosen it.
2. Remove the battery cap and set it aside.
3. Remove the batteries.
4. Place two good batteries, negative (flat) side down, into the battery cylinder.
5. Replace the battery cap on the cylinder and turn it clockwise using a coin to tighten it until it stops.

Important: Do not over-tighten the battery cap. Once the cap stops it is secure.

Press the Mode button once for ½ second to reactivate the PetSafe® GPS Locator™. There is no need to reset or reprogram the device; your Home Zone™ boundary will be preserved.

Using the PetSafe® GPS Locator™ Away from Home

If you plan to take your pet out of your normal Home Zone™ for an extended period of time (for example, when taking a vacation):

1. Remove the batteries from the GPS Locator unit.
 2. Travel to your new location.
 3. Reset the Home Zone.
-

Using the PetSafe GPS Locator Web Site

You can use the PetSafe GPS Locator web site to perform the following tasks:

- Locate your pet
- Change your notification settings
- Place unit in Monitor mode
- Change Home Zone size

To access the PetSafe GPS Locator web site:

1. Using an Internet browser, go to www.PetSafeGPSLocator.com.
 2. Enter your username and password to log into the site. You selected this username and password when you activated the device.
-

About Alerts

Remember, you are encouraged to use any and all notification methods: Home phone, mobile phone, e-mail and text messaging to notify you with an Alert.

With the consolidation of cell phone carriers, be sure we have the correct carrier to ensure you receive timely notification alerts.

In case of e-mail, configure any junk mail/spam filter to ensure you receive timely notification alerts.

Frequently Asked Questions

Who do I call if my pet is lost or I have been notified of a Home Zone violation?	You should call our Customer Care Center at 1-866-900-1102 and press option 1 when prompted. Our support staff is standing by 24-7-365 to help you and your pet get back together.
Who do I call if I have a question or issue with my product?	Call our Customer Care Center at 1-866-900-1102 and press option 2 when prompted, Monday through Friday from 8 a.m. to 8 p.m. EST or Saturday from 9 a.m. to 5 p.m. EST. Please use option 2 as option 1 is for emergency use for when you pet is lost and not for general questions, product issues or purchases.
Why am I not contacted immediately when my pet escapes?	The PetSafe® GPS Locator™ uses an asleep/awake cycle to extend the battery life. Should your pet leave the Home Zone™ during the asleep cycle a notification will not be sent immediately, however once the PetSafe GPS Locator goes into the awake cycle you will receive a notification if your pet is still outside the Home Zone. This can take up to 15 minutes.
What happens if my pet escapes while in Walk Mode?	If your pet escapes while in Walk Mode, call the Customer Care Center at 1-866-900-1102. The Customer Care Specialist will assist you in locating your pet.
How do I know the device is working?	An easy way to determine if the PetSafe GPS Locator is working is to set it to Walk Mode. Be sure to reset it to Monitor Mode.
After I receive a low battery alert, how much time do I have to replace the batteries before they die?	You have approximately 24 hours from a low battery alert to change out the batteries. However, we recommend that you change out the batteries at your earliest opportunity to ensure adequate battery life in the event your pet is ever lost.
Why do I get a low battery alert?	This is a safety feature. If your pet escaped, and the battery had very little life remaining, then the unit could run out of power during the tracking of your pet.
I have replaced my batteries, but I am no longer receiving any alerts.	Please ensure that each time the batteries are replaced, you re-initialize the unit. Press the Mode button one time; red and green LEDs will light, and then go off.
Once I register the product, how long does it take to become activated?	The recognition of your GPS locator normally takes from 4 to 24 hours. It may take longer if you register over a weekend.
Is the PetSafe GPS Locator website compatible with my PDA or mobile device?	The PetSafe GPS Locator website is currently not compatible with browsers typically found in PDA or mobile devices. We are working towards a solution that will provide mobile/PDA users the ability to access the tracking site. Thank you for your patience.
What is the recommended minimum/maximum range for my Home Zone GPS boundary?	Your PetSafe GPS Locator works in a Home Zone that extends from a center point that you establish. By default, the Home Zone radius is set at 300 feet. It can be adjusted to as high as 50 miles away. Due to the accuracy of GPS, it is recommended that the Home Zone not be set less than a 300 feet radius or a false violation may occur.

Terms of Use and Limitation of Liability

1. Terms of Use

This Product is offered to you conditioned upon your acceptance without modification of the terms, conditions and notices contained herein. Usage of this Product implies acceptance of all such terms, conditions, and notices.

2. Proper Use

This Product is designed for use with pets where training is desired. The specific temperament of your pet may not work with this Product. We recommend that you not use this Product if your pet is less than 8 pounds or if your pet is aggressive. If you are unsure whether this is appropriate for your pet, please consult your veterinarian, certified trainer or contact our Customer Care Center at 1-866-900-1102.

Proper use includes reviewing the entire Operating Guide provided with your Product and any specific Caution statements.

3. No Unlawful or Prohibited Use

This Product is designed for use with pets only. This pet training device is not intended to harm, injure, or provoke. Using this Product in a way that is not intended could result in violation of Federal, State or local laws.

4. Limitation of Liability

In no event shall Radio Systems® Corporation be liable for any direct, indirect, punitive, incidental, special or consequential damages, or any damages whatsoever arising out of or connected with the use or misuse of this Product. Buyer assumes all risks and liability from the use of this Product.

5. Modification of Terms and Conditions

Radio Systems Corporation reserves the right to change the terms, conditions and notices under which this Product is offered.

Care and Cleaning

To prevent skin irritation from occurring your dog's neck should be washed weekly with a washcloth and mild hand soap, then rinsed thoroughly.

Product Warranty

Please register your product online at www.PetSafeGPSLocator.com. All parts are covered under warranty for the life of this product. Labor is covered for the first year of ownership. Thereafter, there is a minimum service charge for the repair or replacement of the product. Misuse, loss, damage by pet or improper use or handling is not covered. PetSafe® will not pay for loss of time, inconvenience, loss of use of your product or any incidental or consequential damage. Warranty void if product resold. Please contact the Customer Care Center at 1-866-900-1102 if you need service or for help in troubleshooting and, if needed, to arrange a repair for your product (a service charge may apply). Also, please visit our website at www.PetSafeGPSLocator.com for Frequently Asked Questions and Troubleshooting Tips.

FCC Compliance

This equipment has been tested and found to comply with the limits for a Class B digital device, pursuant to Part 15 of the FCC rules. Unauthorized changes or modifications to the equipment that are not approved by Radio Systems® Corporation are in violation of FCC regulations and could void the user's authority to operate the equipment and void the warranty.

Perchlorate

This product uses Lithium batteries. Lithium batteries may include Perchlorate Material – special handling may apply. See www.dtsc.ca.gov/hazardouswaste/perchlorate.

PetSafe® GPS Locator™

IMPORTANT! Write your serial number here:

Call us at 1-866-900-1102

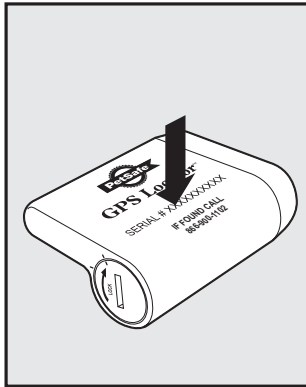

Radio Systems Corporation
10427 Electric Avenue
Knoxville, TN 37932
1-866-900-1102
www.petsafe.net
400-869/1